

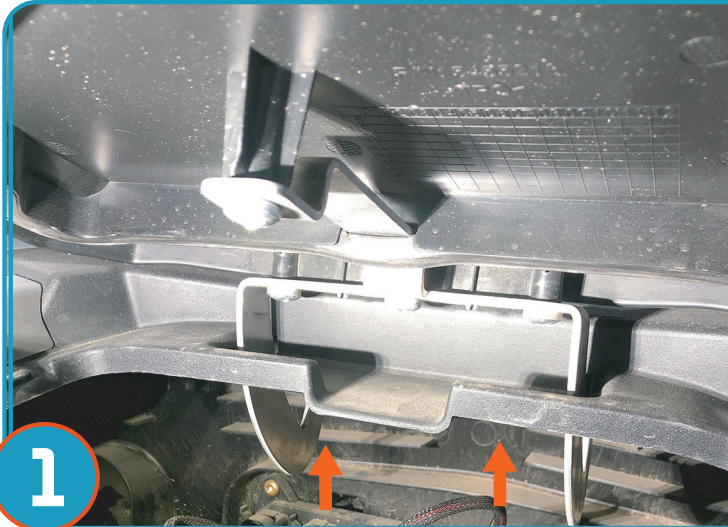

GLOVE BOX HINGE INSTRUCTIONS (P199C049-52)

NOTE: REMOVE THE GLOVE BOX LINER TO ACCESS THE HINGE



Remove glove box liner and remove (2) screws at the base of the hinge separating it from the plastics. Remove (4) screws holding the hinge to glove box panel/lid.

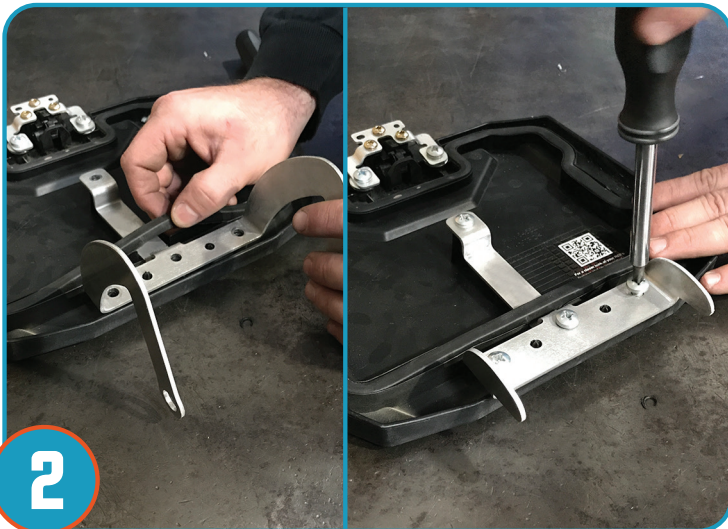

Replace new hinge using the (4) screws removed in step 1. Slide hinge between rubber gasket and glove box plastics.

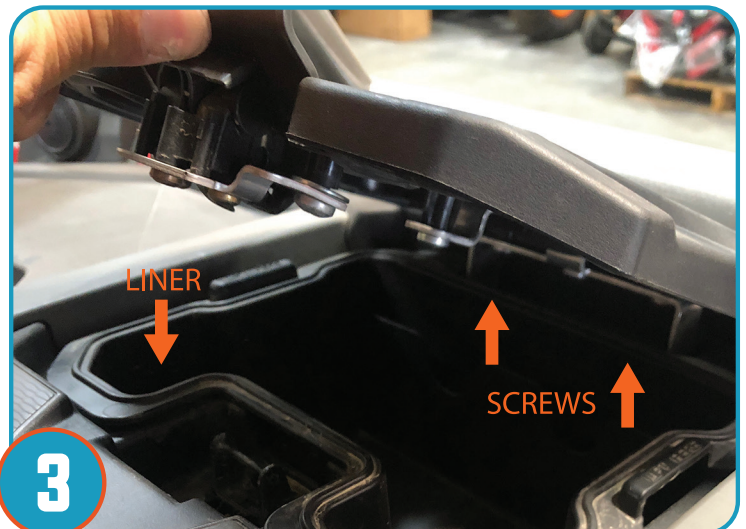

Re-insert the glove box liner then re-insert glove box lid with new hinge. The (2) screws removed in step 1 will not be re-used. Proceed with Pro Armor cage install.

- **Never** stick hands, head or arms outside of vehicle at any time when it is in motion.
 - **Always** wear and use proper safety equipment when using any Pro Armor product.
 - Improper use of directions and/or product can result in injury to yourself or damage to your vehicle.
 - **Disclaimer please read:** This product is sold without warranty expressed or implied. No warranty or representation is made as to the products ability to protect the user / occupant from any injury or death in any manner of use. The user assumes that risk. The effectiveness of this equipment is directly related to the manner in which it is installed, used, and / or maintained.
- Proper installation is solely the responsibility of the installer, and will not be assumed by Pro Armor.**
- If you have questions about your installation or are unable able to complete installation, contact Pro Armor Customer Service (888)312-7667 or have an authorized dealer or trained technician, inspect your installation.

WARNING